

PRINTMASTER SERIES

MAGAZINE LOADING, HIGH SPEED,
HOT FOIL OVERPRINTERS

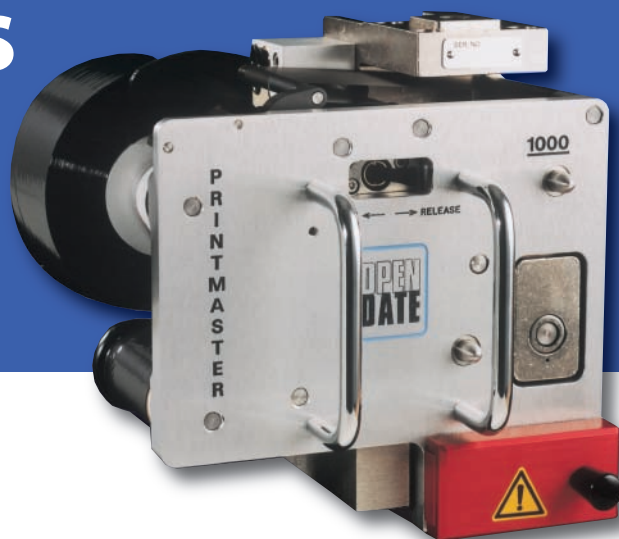

FEATURES

- ▶ Simple to use
- ▶ Available in left and right hand versions
- ▶ Up to 1,200 prints per minute
- ▶ Easy to install on packaging and labelling machines
- ▶ 305 metre (1,000ft) foil capacity
- ▶ Easy fit foil magazine
- ▶ Fully variable temperature control
- ▶ Digital electronic control unit
- ▶ End of foil alarm
- ▶ Printer fault signal output
- ▶ Quality engineered product
- ▶ Full safety specification
- ▶ Stainless steel main air cylinder
- ▶ Interlocked type holder access door
- ▶ Positive foil drive with infinite adjustment
- ▶ Rotary numbering units (flickwheel) optional

The Printmaster range of Hot Foil overprinters has a worldwide reputation for quality and reliability, whilst the print speed potential is unrivalled. They can be attached to any reel fed packaging or labelling machine using either standard or custom designed mounting frames to provide an extremely versatile and durable in-line coding and overprinting facility. They are simple to use and require only minimal maintenance.



World Class Coding & Marking Systems



*getting you
up to speed*

PRINTMASTER SERIES



SPECIFICATIONS

	PRINTMASTER 1000	PRINTMASTER PLUS	PRINTMASTER "S"
Print Area	50 x 25mm	50 x 40mm	50 x 20mm
Operating Speed – Maximum	700 per minute	300 per minute	1,200 per minute
Cycle Time – Minimum	80 milliseconds	175 milliseconds	30 milliseconds
Air Cylinder	40 dia x 13mm		40 dia x 7mm
Free Air Consumption per Cycle	228cc @ 6.8 bar		122cc @ 6.8 bar
Dwell Time Range	12 - 650 milliseconds		*6-360 milliseconds
End of Foil Alarm	Standard		
Foil Capacity	305m (1,000ft)		
Foil Width – Maximum	58mm		
Foil Feed Adjustment	Positive, accurate and infinitely adjustable		
Operating Air Pressure	4.0 to 6.8 bar (60 to 100 PSI)		
Print Head Dimensions	195 x 223 x 160mm		
Printer Weight	5.25kg		
Temperature Range	Variable between 70 and 220°C		
Operating Voltage	110/240v AC, 50/60 Hz		
Control Unit Dimensions	240 x 145 x 66mm		

* Controls supplied with multi-turn dwell potentiometer as standard

INSTALLATION DETAILS

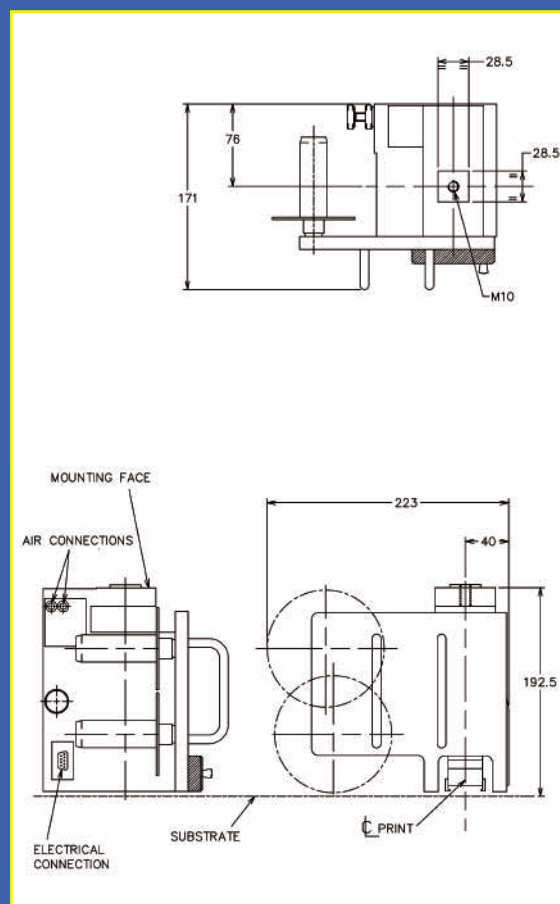

MOUNTING FRAME

The optional Printmaster mounting frame is the basis for most installations. It can be supplied in a standard form or ready adapted to suit specific parent machinery.

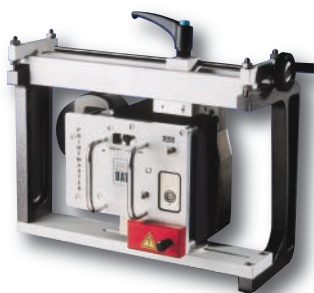

CONTROL UNIT

The Printmaster's digital display controller enables simple yet precise control of print dwell times and operating temperatures to provide the optimum print quality. It features indicators for end of foil, open door, heater failure and temperature sensor failure.



PPMA



Open Date Equipment Ltd
Units 8 & 9 Puma Trade Park
145 Morden Road
Mitcham, Surrey, CR4 4DG.
UNITED KINGDOM
Tel: +44 (0)20 8655 4999
Fax: +44 (0)20 8655 4990
Email: sales@opendate.co.uk
Web site: www.opendate.co.uk

Open Date Systems Inc
Springfield Road, PO Box 538
Georges Mills, NH 03751
U.S.A.
Tel: +(1) 603 763 3444
Fax: +(1) 603 763 4222
Toll free: 877-OPENDATE
Email: info@opendate.com
Web site: www.opendate.com

Open Date France
Z.I. D'Attichy
60350 Attichy
France
Tel: +33 (0) 344 42 94 43
Fax: +33 (0) 344 42 17 17
Email: info@opendatefrance.com
Web site: www.opendatefrance.com

Open Date GmbH
Mittlere Stämmig 4
97297 Üttingen
Germany
Tel: +49 (0) 9369 98 24 0
Fax: +49 (0) 9369 98 24 24
Email: sales@opendate.de
Web Site: www.opendate.de