

# PRINTMASTER SERIES



**MAGAZINE  
LOADING,  
HIGH SPEED,  
HOT FOIL  
OVERPRINTERS**

The Printmaster range of Hot Foil overprinters have a worldwide reputation for quality and reliability whilst the print speed potential is unrivalled. The Printmaster "S" can produce an overprint in less than 50 milliseconds giving attainable operating speeds in excess of 1200 prints per minute. All machines feature large capacity, 305 metre (1000ft) foil magazines.

Printmaster Hot Foil units are simple to use, requiring minimum maintenance. They can be attached to any reel fed packaging or labelling machine using either standard or custom designed mounting frames to provide an extremely versatile and durable in-line coding and overprinting facility.

Prints are clear, dry, non-toxic and are of a quality that cannot be matched by any other in-line overprinting process.

## FEATURES

- Left and right hand versions available
- Lightweight easy loading foil magazine
- Simple, reliable electronic controls
- Fully variable temperature control
- Digital electronic control unit - optional
- End of foil alarm with user output
- Full safety specification
- All stainless steel purpose designed air motor
- Interlocked type holder access door
- Positive foil drive with infinite adjustment
- Rotary numbering units (flickwheel) optional.



# PRINTMASTER SERIES

SPECIFICATIONS	PRINTMASTER 1000	PRINTMASTER PLUS	PRINTMASTER "S"
Print Area	50 x 25mm	50 x 40mm	50 x 20mm
Operating Speed – Maximum	700 per minute	300 per minute	1200 per minute
Cycle Time – Minimum	80 milliseconds	175 milliseconds	30 milliseconds
Air Cylinder	40 dia x 13mm		40 dia x 7mm
Free Air Consumption per Cycle	228cc @ 6.8 bar		122cc @ 6.8 bar
Dwell Time Range	12-650 milliseconds		*6-360 milliseconds
End of Foil Alarm	Standard		
Foil Capacity	305m (1000')		
Foil Width – Maximum	58mm		
Foil Feed Adjustment	Positive, accurate and infinitely adjustable		
Air Pressure	4.0 to 6.8 bar (60 to 100 PSI)		
Print Head Dimensions	195 x 223 x 160mm		
Printer Weight	5.25kg (11.5lbs)		
Temperature Range	Variable between 70 and 220 degrees C		
Operating Voltage	110 or 240v AC, 50/60 Hz		
Control Unit Dimensions	240 x 145 x 66mm		

\* Controls supplied with multi-turn dwell potentiometer as standard.

## INSTALLATION DIMENSIONS

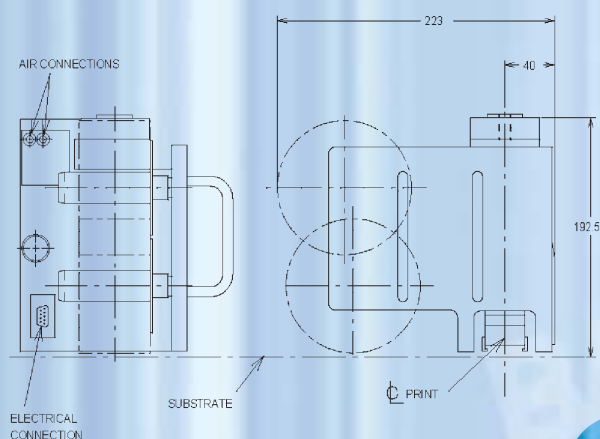
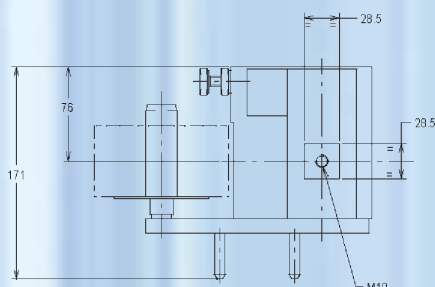

The optional Printmaster mounting frame is the basis for most installations. It can be supplied in a standard form or ready adapted to suit specific parent machinery.



The standard electronic control unit is simple to use and incorporates infinitely variable print dwell and temperature controllers. The optional digital display controller enables the user to enter exact dwell times in milliseconds and temperatures in degrees Centigrade or Fahrenheit. It features indicators for end of foil, open door, heater failure and thermistor failure.



**Open Date Equipment Ltd.**  
Units 8 & 9 Denvale Trade Park  
145 Morden Road  
Mitcham  
Surrey, CR4 4DG. U.K.  
Tel: +44 (0)20 8655 4999  
Fax: +44 (0)20 8655 4990  
Email: [sales@opendate.co.uk](mailto:sales@opendate.co.uk)  
Web site: [www.opendate.co.uk](http://www.opendate.co.uk)

**Open Date Systems, Inc.**  
Springfield Road, PO Box 538  
Georges Mills, NH 03751  
U.S.A.  
Tel: +1 (603) 763 3444  
Fax: +1 (603) 763 4222  
Toll free: 877-OPENDATE  
Email: [info@opendate.com](mailto:info@opendate.com)  
Web site: [www.OpenDate.com](http://www.OpenDate.com)

**Open Date France**  
Z.I. D'Attichy  
60350 Attichy  
France  
Tel: +33 (0) 344 42 94 43  
Fax: +33 (0) 344 42 17 17  
Email: [opendate@wanadoo.fr](mailto:opendate@wanadoo.fr)

**Open Date GmbH**  
Schräggasse 14  
97264 Helmstadt  
Germany  
Tel: +49 (0) 9369 990026  
Fax: +49 (0) 9369 990036  
Email: [sales@opendate.de](mailto:sales@opendate.de)  
Web Site: [www.opendate.de](http://www.opendate.de)